

DRS24C & R Series

Z-Axis Motor Belt Replacement

Section 3.0

Replacing your Z-axis motor belt

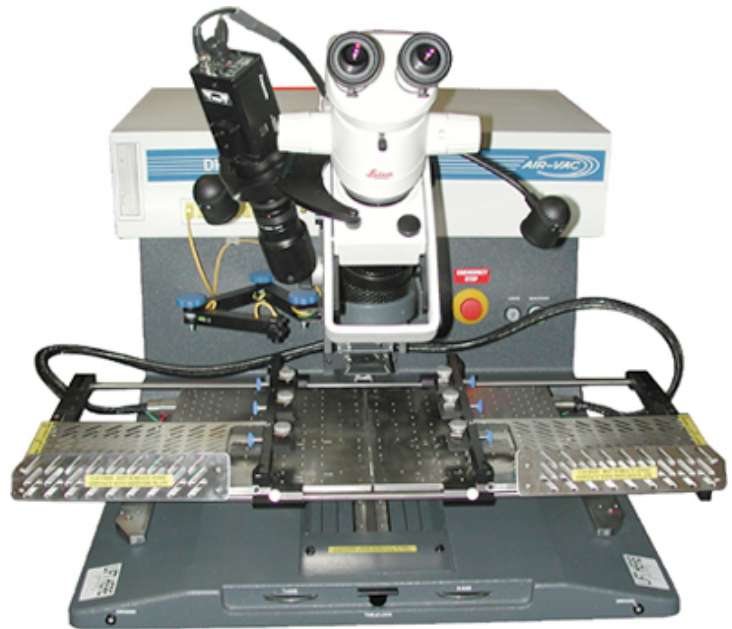

 **BEFORE YOU START:**

Read instructions thoroughly before beginning.



ELECTRICAL WARNING:

POWER DOWN DRS24 AND DISCONNECT FROM POWER SOURCE.



CHECKLIST:

The following items will be needed in this section.

- M5 Allen wrench
- M2.5 Allen wrench
- Z-axis motor belt part no. 22.22.006

For technical problems, please contact the Air-Vac technical service department at:

Air-Vac Engineering Company, Inc.

30 Progress Avenue • Seymour, CT 06483

Phone: 203-888-9900 • Fax: 203-888-1145

e-mail: solder.tech@air-vac-eng.com • www.air-vac-eng.com • 03/26/01

3.0 Z-Axis Motor Belt Replacement

! IMPORTANT

VERIFY DRS24 IS DISCONNECTED FROM THE POWER SOURCE.

NOTE 

The Z-axis motor belt is located under the front right side of the upper casting (A), (fig.1).

✓ STEPS:

- 1** Remove 4 screws (2 front, 2 rear) (B), (fig.1), holding upper casting (A) to DRS24 chassis.

Fig. 1

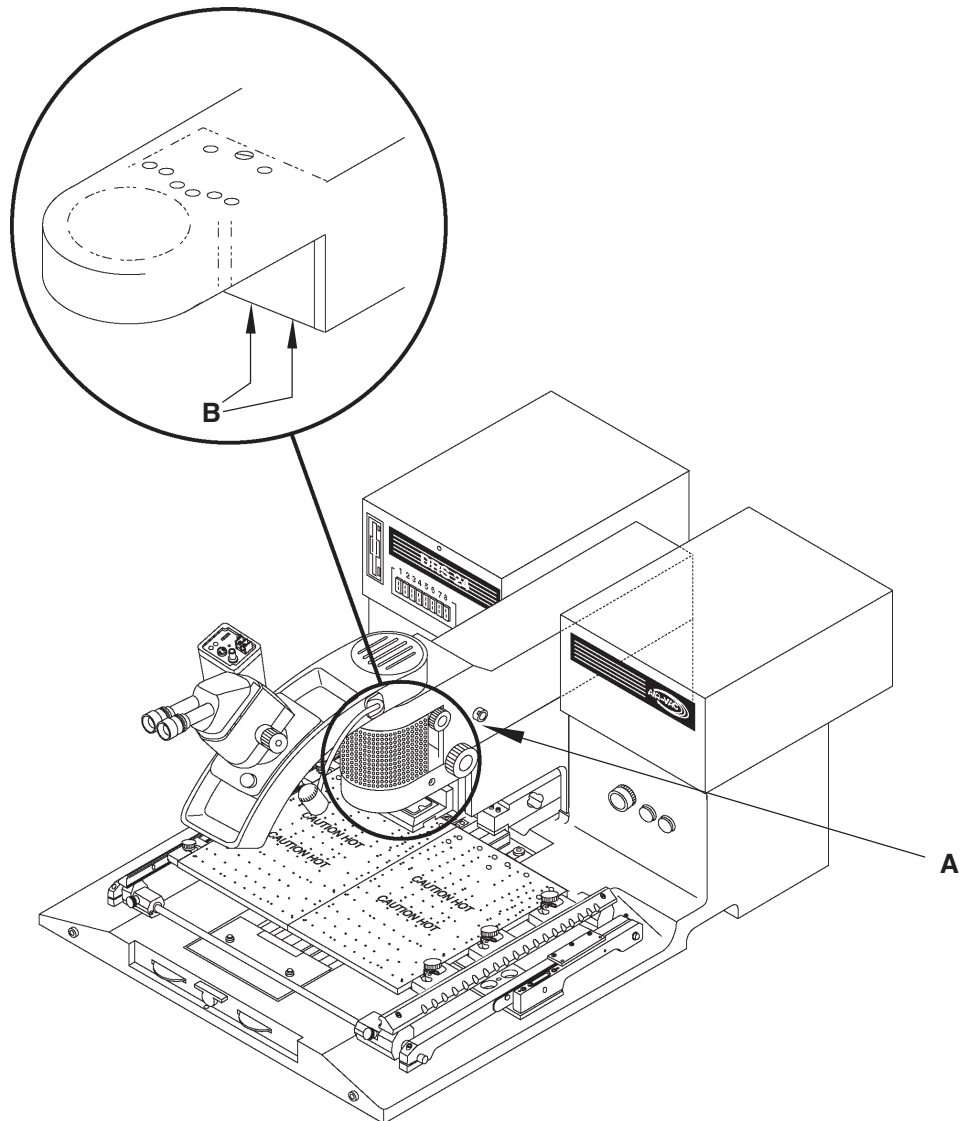

- 2** Lift casting (C), (fig.2), slowly, unplug 2 connectors (D) located inside casting, and set casting aside.
- 3** Remove 2 screws (E) holding front screen (F), and remove screen.
- 4** Manually lower Z-axis (G) down.
- 5** Remove screws holding clamp (H) to belt (I) and remove clamp.

- 6 Push belt off pulley (J) as you turn Z-axis knob (K).
- 7 Once belt is off of top pulley, it will come out of casting.
- 8 Reverse these steps to install the new belt.

NOTE  **Make sure belt is fully on top pulley.**

- 9 Once belt is on and the Z-axis moves freely, put a couple of drops of crazy glue on the belt clamps (H) and belt (I) to secure belt to the clamp.

